



*Welcome to Alcovy Lakes...  
a Lifestyle of Luxury and Natural Beauty*







# Alcovy Lakes

Alcovy Lakes is an enclave of magnificent homes and elegant estates surrounded by natural beauty in Walton County. Three pristine lakes provide the focal point of the community and an ideal spot for recreational activities, along with a beautiful park for all residents to enjoy!

Alcovy Lakes offers a variety of wooded lots ranging from one acre to 25 acres. To uphold and enhance property values, a variety of protective covenants and design standards will allow each home to be architecturally distinctive, yet conform to the traditional character of Alcovy Lakes.

- Declaration of Covenants, Conditions, and Restrictions
- Design Guidelines for New Construction and Modifications
- Articles of Incorporation of Alcovy Lakes Community Association

Picturesque, wooded lots averaging 3+ acres and larger

Homes ranging from \$500,000 to \$700,000, with some over \$1 Million

Community park with playground equipment and lakes for boating & fishing

Protective covenants, architectural guidelines & requirements









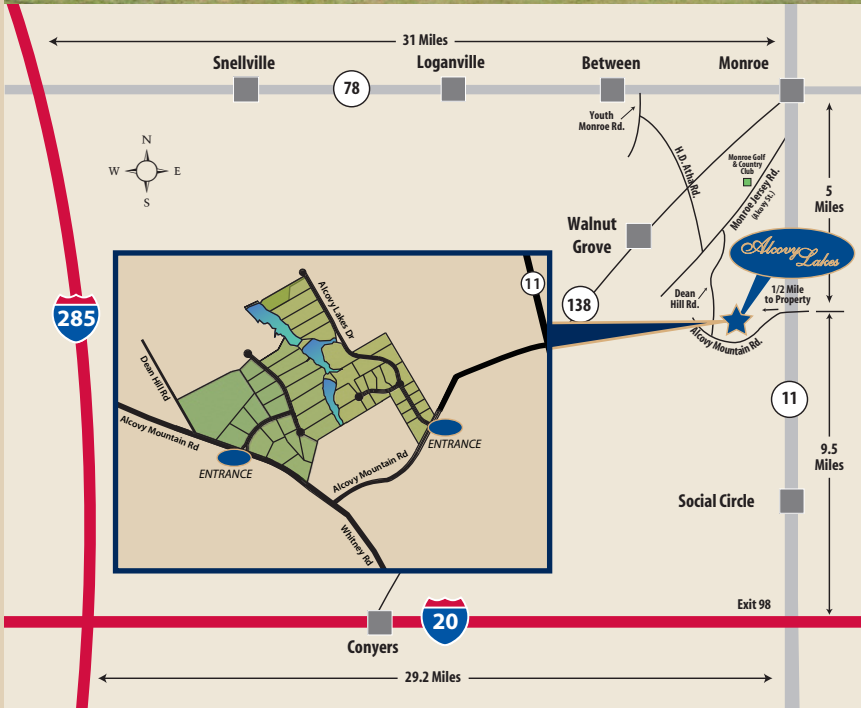

## *Directions from Atlanta*

**FROM I-285 & US HIGHWAY 78:**

*Travel east on US Highway 78  
toward Snellville & Athens for 31 miles.*

*Exit at GA Highway 11 (Monroe/Winder).*

*Turn right (going south) at GA Highway 11  
and drive 5 miles.*

*Turn right at Alcovy Mountain Road  
and drive 1/2 mile.*

*Turn right into Alcovy Lakes entrance.*

**FROM I-285 & I-20:**

*Travel East on Interstate 20 for 29.2 miles.*

*Exit at #98 (Highway 11, Monroe/Monticello  
and Social Circle/Mansfield).*

*Turn left (going north) at GA Highway 11  
and drive 9.5 miles.*

*Turn left at Alcovy Mountain Road  
and drive 1/2 mile.*

*Turn right into Alcovy Lakes entrance.*

Information contained herein has been provided to broker by owner or from other sources. We have no reason to doubt its accuracy, but we do not guarantee it. Broker disclaims all expressed or implied responsibilities for omissions, errors, environmental conditions of soil/structure, operating systems, the roof, price and compliance with applicable laws. Suitability for intended use or any other matter is the responsibility of purchaser or tenant. Prospective purchasers or tenants agree to independently obtain and analyze all material information. Owner/Agent

***George W. Baker III***

Cell 770-883-5541  
Office 770-266-6154  
george@baker-groupllc.com

***George W. Baker, Jr.***

Cell 770-883-5551  
Office 770-266-6153  
gbakerjr@baker-groupllc.com

**BAKER**  
*Real Estate Services*  
**GROUP**  
*Baker-GroupLLC.com*